



3/58 Moulden Avenue Yokine WA

3 1 2

Be quick to view this lovingly renovated and maintained 3 bedroom townhouse, and let its ideal layout, stylish kitchen, large bedrooms and roomy courtyard demonstrate to you why this is your ideal new home!

Offering 2 expansive bedrooms with built in robes, and which provide ample room for a king size bed & more, plus a standard size 3rd bedroom, this uniquely designed townhouse offers you the space of a large home within its low maintenance style shell.

Intelligently designed, with all the main living areas located downstairs, including the recently renovated and generously sized kitchen, that features ample bench and cupboard space, stainless steel appliances and direct access to the separate and dedicated laundry, convenient second toilet, along with the delightful open plan lounge &

View : <https://www.prestigepropertyperth.com.au/lease/wa/northern-suburbs/yokine/residential/townhouse/6195446>



Amber Amos
08 6225 5151

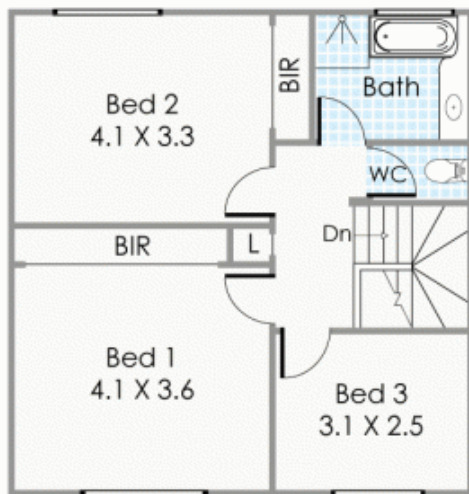

First Floor

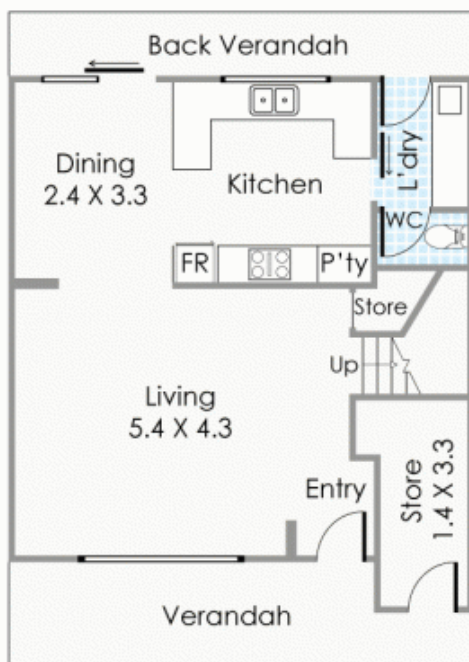

Ground Floor



Approximate Areas

Ground Floor / Store: 56m²

First Floor: 55m²

Carport: 31m²

Verandah: 11m²

Back Verandah: 8m²

Total Area: 161m²

(Not Actual Location)

This floorplan is for illustration purposes only to show the layout of the property. Measurements and total areas do not include or account for wall thickness or roof area under eaves. Not to be used for any other purpose.
www.cribcreative.com.au

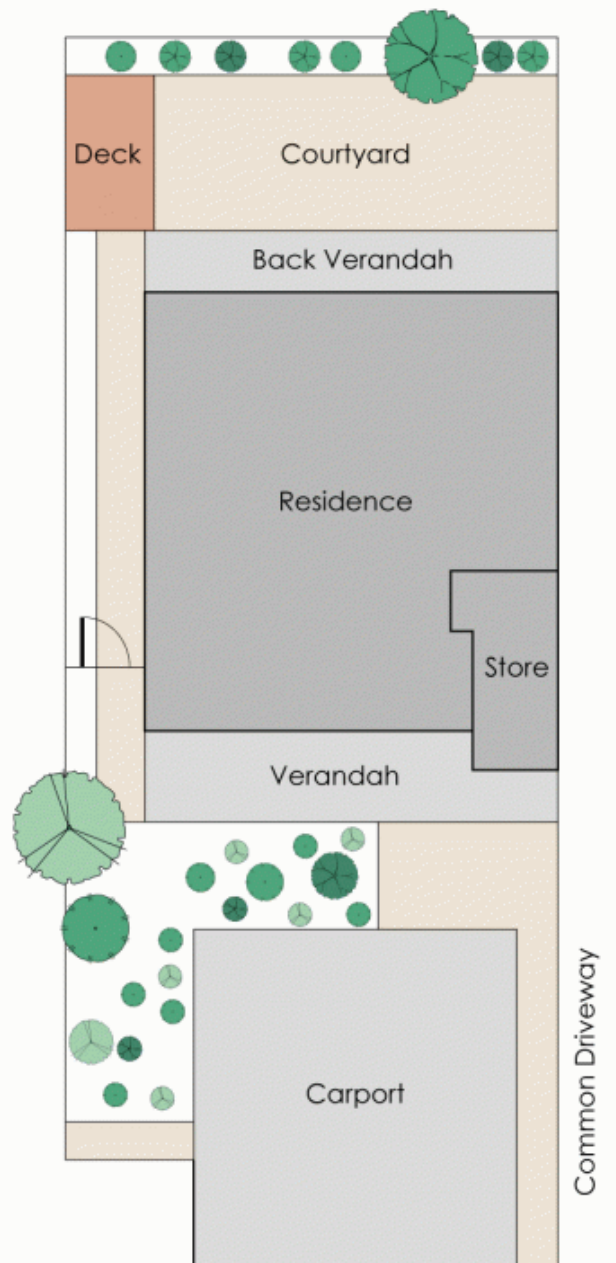

3/58 Moulden Avenue, Yokine